

8125H

120V-277V Universal Voltage

Catalog #:		Type
Project:		Date
Prepared by:		

8" LED Frame-In

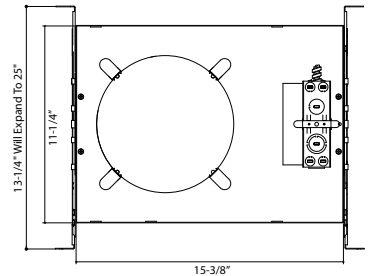
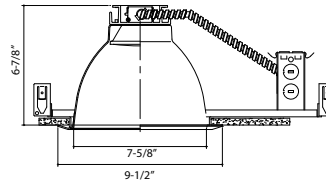

8" LED Frame-In

DESCRIPTION

An ideal solution for efficiency, safety, and flexible design aesthetics. The 8125H housing - frame/module/trim combo balances power, efficiency and cost to bring you the options needed to complete a variety of residential or commercial projects with a reliable and modern LED down light solution.

DESIGN FEATURES

Electrical

- 120V-277V Universal Voltage
- Triac & 0-10V dimming with integral driver
- Suitable for use in damp locations, wet locations when used with 8673WH
- 50,000 hour projected life
- Beam angle 60°
- 23W, 1950lms | 30W, 2720lms | 45W, 3640lms
- Available in 3000K, 3500K, 4000K

Housing

- 23W, 30W, or 43W power options
- Sturdy aluminum construction
- Suitable for use in new construction applications
- 7-11/16" height allows for use in 2" x 8" joist construction

Junction Box

- Listed for through branch circuit wiring and includes five (5) 3/4" knockouts
- Easy access plate for quick wiring

Bar Hanger

- Included heavy-gauge captive bar hanger allow the housing to be secured to both joist or suspended "T" bar construction
- Adjustable to position the housing at any point within a 24" joist span or grid section
- 4 captive nails for quick placement

Dimensions

- Size: 15-3/8" x 11-5/16" x 7-11/16"
- Aperture: 7-5/8"

Emergency Option

- 8125H-__-__-EM

Certifications

- Energy Star - 3000K & 4000K Only
- cCSAus
- 5 year limited warranty



TEL: 800.937.6925 | Fax: 800.207.9509 | www.rplighting.com

Specifications and dimensions subject to change without notice.

8125H

120V-277V Universal Voltage

Specification & Ordering

HOUSING

Example: 8125H-30-4K-EM

Housing #	Wattage	CCT	Emergency Battery Backup
	8125H		
	8125H	-23 : 23W, 1950lms -30 : 30W, 2720lms -45 : 45W, 3640lms	-3K : 3000K -35K : 3500K -4K : 4000K

MODULE/TRIM

Example: 8671HZ

Module/Trim #	Finish
	8671
	8671 Haze cone reflector

MODULE/TRIM

Example: 8672WH

Module/Trim #	Finish
	8672
	8672 Haze reflector with white baffle

MODULE/TRIM

Example: 8673WH

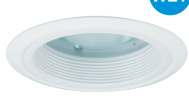
Module/Trim #	Finish
	8673
	8673 Haze Reflector with lens

MODULE/TRIM

Example: 8674WH

Module/Trim #	Finish
	8674
	8674 White reflector with floating lens

Compatible Dimmers:

- Lutron (Triac)
 - S-603PG, DVELV-303P, CT-103P, SELV-300P, DCVCL-153P, DV-600P, MAELV-600, FAELV-500, TCGL-153P, TG-600P, S-600P, LG-600P, IP106-1LZ, 6631-2, 6683-IW, IPE04, 6161, 6633-P, VPE06
- Cooper (Triac)
 - SLC03P, DLC03P, DAL06P
- Lutron (0-10V)
 - Nova series (part# NFTV)
 - DIVA series (part# DDTV)
- Leviton
 - Illuma Tech series (part# IP710-DL)

TEL: 800.937.6925 | Fax: 800.207.9509 | www.rplighting.com

Specifications and dimensions subject to change without notice.