



JOB NAME:

CAT#:

TYPE:

### APPLICATIONS

The LED 45 degree linear strip is ideal for interior warehouse, retail, and utility areas requiring general illumination in a commercial quality strip configuration. The CL45's angled housing makes it perfect for wall and corner applications.

### FEATURES & BENEFITS

- Housing is die-formed and embossed code 22 gage steel
- Finish is high reflectance baked white enamel
- Ballast covers or reflectors attach without tools to simplify ballast access
- End plate doubles as a coupler for continuous row mounts
- Surface mount chain, chain hung, double stem



### DIMENSIONS

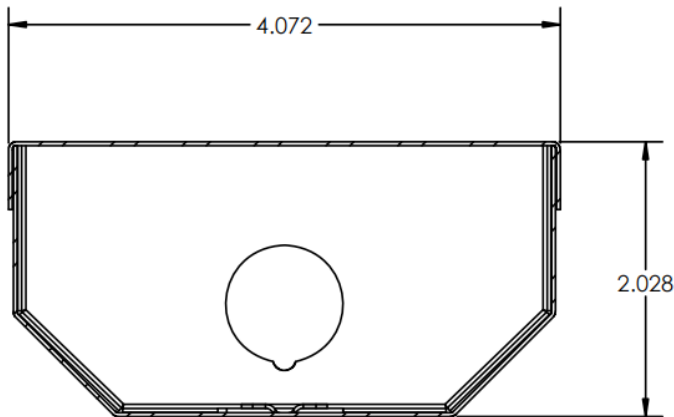

Dimensions and specifications subject to change without notice.





JOB NAME:

CAT#:

TYPE:

**ORDERING**

EXAMPLE: CL45 24 ED 18 DMV 30 EM WP P11

CL45		LED							
1. SERIES	2. SIZE	3. GEAR	4. WATTAGE/LUMENS		5. DRIVER		6. COLOR TEMP		7. EM(O) <sup>1</sup>
<b>CL45</b>	<b>24</b> 24"	<b>LED</b>	<b>24 in.</b>		<b>DMV</b> 120-277V Multivolt 0-10V Dimmable	<b>30</b> 3000K	<b>EM</b>	10W Emergency battery backup	
LED 45	<b>48</b> 48"		<b>18</b> 18 Watts 2500 Lumens	<b>35</b> 3500K				<b>EM5</b>	5W, 600 Lumen battery backup
Degree	<b>96</b> 96"		<b>24</b> 24 Watts 3350 Lumens	<b>40</b> 4000K		<b>EM7</b>	7W, 840 Lumen battery backup		
Linear Strip			<b>28</b> 28 Watts 3700 Lumens	<b>50</b> 5000K					
			<b>30</b> 30 Watts 8100 Lumens						
			<b>48 in.</b>						
			<b>24</b> 24 Watts 3500 Lumens						
			<b>30</b> 30 Watts 4300 Lumens						
			<b>35</b> 35 Watts 4900 Lumens						
			<b>48</b> 48 Watts 6500 Lumens						
			<b>57</b> 57 Watts 7800 Lumens						
			<b>72</b> 72 Watts 8200 Lumens						
			<b>96 in.</b>						
			<b>24</b> 24 Watts 3500 Lumens						
			<b>48</b> 48 Watts 6500 Lumens						
			<b>57</b> 57 Watts 7800 Lumens						
			<b>70</b> 70 Watts 9800 Lumens						
			<b>97</b> 97 Watts 13000 Lumens						
			<b>118</b> 118 Watts 15500 Lumens						

8. WHIP(O) <sup>1</sup>		9. PLUG IN OPTIONS(O) <sup>1</sup>	
<b>WP</b>	6 ft. 3 wire 18 gauge whip	<b>P11</b>	3 wire harness, including white, black, and green
<b>WP4</b>	6 ft. 4 wire 18 gauge whip	<b>P12</b>	4 wire harness, including white, black, green, and blue for emergency battery backup
		<b>P13D</b>	5 wire harness, including white, black, green, violet, and gray

**Notes:**  
<sup>1</sup>(O) is optional

Dimensions and specifications subject to change without notice.

