

FL2103D-B FL2105D-B FL2106D-B



Vanity

Features

Housing

Die-formed Cold-rolled Steel

Optical

Shade: High Transmission Acrylic Create Excellent Light Distribution and Uniformity

LED: High Efficiency, High CRI, Binned and Mixed to Reach Uniform Light.

Electrical

High Power Factor, Low THD

Lamp

LED Type: Built-in (Color Temperature Option – 3500K, 5000K)

Certification

ETL/cETL Listed, Energy Star

Warranty

5 Years Warranty on Driver and LED Module

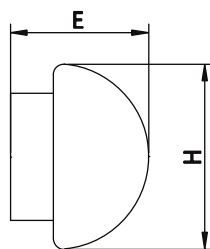

LED Type

Model	Input Voltage	Input Wattage	LED CT / CRI	Lumen (TYP)	Dimension (L X H X E)	Finish	Shade	Energy Star
FL2103D-B-3000K	120V ~ 277V	23W	3000K / 80	1785	24.5" x 5.5" x 4.0"	Silver / Plastic	High Light Transmission Acrylic	Yes
FL2103D-B-4000K	120V ~ 277V	23W	4000K / 80	1850	24.5" x 5.5" x 4.0"	Silver / Plastic	High Light Transmission Acrylic	Yes
FL2105D-B-3000K	120V ~ 277V	34W	3000K / 80	2910	36.5" x 5.5" x 4.0"	Silver / Plastic	High Light Transmission Acrylic	Yes
FL2105D-B-4000K	120V ~ 277V	34W	4000K / 80	3000	36.5" x 5.5" x 4.0"	Silver / Plastic	High Light Transmission Acrylic	Yes
FL2106D-B-3000K	120V ~ 277V	48W	3000K / 80	3420	48.5" x 5.5" x 4.0"	Silver / Plastic	High Light Transmission Acrylic	Yes
FL2106D-B-4000K	120V ~ 277V	48W	4000K / 80	3520	48.5" x 5.5" x 4.0"	Silver / Plastic	High Light Transmission Acrylic	Yes