



**Application:** Commercial; Retail; school/institution; government agency; grocery store....



| Specification               |                         |                       |
|-----------------------------|-------------------------|-----------------------|
| <b>Model No.</b>            | HY-T8-F210-15W-A4000K   | HY-T8-F210-15W-A5000K |
| <b>Power:</b>               | 15W                     |                       |
| <b>Input Voltage:</b>       | AC100-277V              |                       |
| <b>Luminous Flux:</b>       | 1950 LM                 |                       |
| <b>Power Factor:</b>        | >0.9                    |                       |
| <b>THD:</b>                 | <10%                    |                       |
| <b>CCT:</b>                 | 4000K                   | 5000K                 |
| <b>Cover:</b>               | Glass with Frosted Film |                       |
| <b>DLC Family ID</b>        | P22ZF8XJ                | PYRY5K71              |
| <b>CRI:</b>                 | >80                     |                       |
| <b>Working Life:</b>        | >50,000 hours           |                       |
| <b>Working Temperature:</b> | 4°F to 105°F            |                       |

### GENERAL DESCRIPTION

The T8 LED Hybrid Tube is shatter resistant, energy efficient and easy for installation replacement for Fluorescent Tubes. Compatible with existing ballast, this linear tube is thoughtfully designed to be for easy installation.

### FEATURE

- Glass with Outer Film: Prevent the glass break into pieces
- High energy efficiency: save more than 60% energy versus fluorescent lamps
- Ballast compatible: Can be used with existing ballast
- Easy Installation: plug and play
- NOTE: Check the ballast compatibility list before installation

### Installation Guide

1. Disconnect power
2. Remove diffuser (Optional)
3. Removing the existing fluorescent lamp
4. Install the LED Tube Lamp
5. Install diffuser back (if removed in step 2)
6. Turn on power

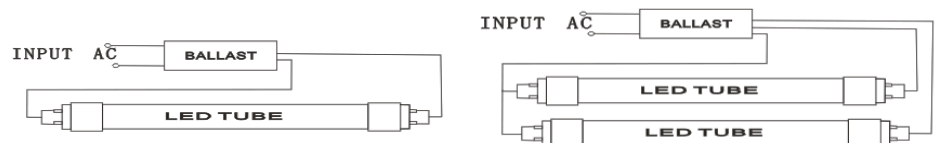
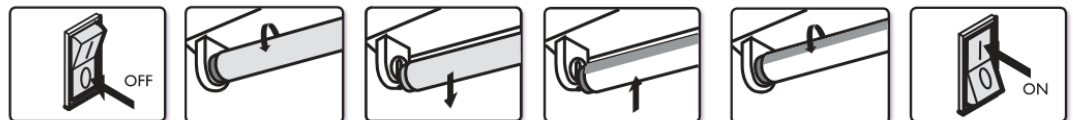

# BALLAST COMPATIBILITY LIST of TYPE A

VERSION : G

UPDATED DATE : 2017/9/01

THE COMPATIBILITY LIST OF BELOW WAS ALL VERIFIED WITH TYPE A

| NUMBER | BRAND OF BALLAST | PRODUCT MODEL      | OUTPUT | STARTING TYPE    |
|--------|------------------|--------------------|--------|------------------|
| 1      | ACCUPRO          | AP-RC-232IP-120-1  | 2-LAMP | INSTANT START    |
| 2      | ACCUPRO          | AP-RC-432IP-120    | 4-LAMP | INSTANT START    |
| 3      | ESPEN            | VE232T8120         | 2-LAMP | INSTANT START    |
| 4      | FULHAM CO., INC  | WH3-120-L          | 2-LAMP | INSTANT START    |
| 5      | FULHAM CO., INC  | WH3-120-C          | 2-LAMP | INSTANT START    |
| 6      | FULHAM CO., INC  | E3 WH3-277-L       | 3-LAMP | INSTANT START    |
| 7      | FULHAM CO., INC  | WHCG3-120-T8-IS    | 4-LAMP | INSTANT START    |
| 8      | FULHAM CO., INC  | WHSG3-UNV-T8-IS    | 3-LAMP | INSTANT START    |
| 9      | GENERAL ELECTRIC | GE-132-MAX-L/ULTRA | 1-LAMP | INSTANT START    |
| 10     | GENERAL ELECTRIC | GE132-MV-N         | 1-LAMP | INSTANT START    |
| 11     | GENERAL ELECTRIC | GE132-MV-PS-L      | 1-LAMP | INSTANT START    |
| 12     | GENERAL ELECTRIC | GE132MAXP-L/ULTRA  | 1-LAMP | INSTANT START    |
| 13     | GENERAL ELECTRIC | GE132MAXP-N/ULTRA  | 1-LAMP | INSTANT START    |
| 14     | GENERAL ELECTRIC | GE132MAX-L/ULTRA   | 1-LAMP | INSTANT START    |
| 15     | GENERAL ELECTRIC | GE132MAX-N/ULTRA   | 1-LAMP | INSTANT START    |
| 16     | GENERAL ELECTRIC | GE132MAX-H/ULTRA   | 1-LAMP | INSTANT START    |
| 17     | GENERAL ELECTRIC | GE132MAX-G-347     | 1-LAMP | INSTANT START    |
| 18     | GENERAL ELECTRIC | GE232MV-N-DIY      | 2-LAMP | INSTANT START    |
| 19     | GENERAL ELECTRIC | GE232MAX-H/ULTRA   | 2-LAMP | INSTANT START    |
| 20     | GENERAL ELECTRIC | GE232MAXP-H/ULTRA  | 2-LAMP | INSTANT START    |
| 21     | GENERAL ELECTRIC | GE232-120RES-DIY   | 2-LAMP | INSTANT START    |
| 22     | GENERAL ELECTRIC | GE232MAX347-N      | 2-LAMP | INSTANT START    |
| 23     | GENERAL ELECTRIC | GE-232-MVPS-H      | 2-LAMP | PROGRAMMED START |
| 24     | GENERAL ELECTRIC | GE-232-MV-PS-L     | 2-LAMP | PROGRAMMED START |
| 25     | GENERAL ELECTRIC | GE232MAX-L/ULTRA   | 2-LAMP | INSTANT START    |
| 26     | GENERAL ELECTRIC | GE232 MA           | 2-LAMP | INSTANT START    |
| 27     | GENERAL ELECTRIC | GE232MAX-G-N       | 2-LAMP | INSTANT START    |
| 28     | GENERAL ELECTRIC | GE232-120-RES      | 2-LAMP | INSTANT START    |
| 29     | GENERAL ELECTRIC | GE-232-MV-PS-N     | 2-LAMP | PROGRAMMED START |
| 30     | GENERAL ELECTRIC | GE232-120RESDIYB   | 2-LAMP | INSTANT START    |
| 31     | GENERAL ELECTRIC | GE-232-MV-N-42T    | 2-LAMP | INSTANT START    |
| 32     | GENERAL ELECTRIC | GE232MAX-G-N-DIYB  | 2-LAMP | INSTANT START    |
| 33     | GENERAL ELECTRIC | GE232MAX-N/ULTRA   | 2-LAMP | INSTANT START    |
| 34     | GENERAL ELECTRIC | GE259MAX-G-N-DIYB  | 2-LAMP | INSTANT START    |
| 35     | GENERAL ELECTRIC | GE259MAX-G-N       | 2-LAMP | INSTANT START    |
| 36     | GENERAL ELECTRIC | GE332MV-N-DIY      | 3-LAMP | INSTANT START    |
| 37     | GENERAL ELECTRIC | GE332MAX-L/ULTRA   | 3-LAMP | INSTANT START    |
| 38     | GENERAL ELECTRIC | GE332MAX-G-N       | 3-LAMP | INSTANT START    |

# BALLAST COMPATIBILITY LIST of TYPE A

VERSION : G

UPDATED DATE : 2017/9/01

**THE COMPATIBILITY LIST OF BELOW WAS ALL VERIFIED WITH TYPE A**

| NUMBER | BRAND OF BALLAST  | PRODUCT MODEL       | OUTPUT | STARTING TYPE    |
|--------|-------------------|---------------------|--------|------------------|
| 39     | GENERAL ELECTRIC  | GE332MAX-G-N-DZYB   | 3-LAMP | INSTANT START    |
| 40     | GENERAL ELECTRIC  | GE332MAX-L          | 3-LAMP | INSTANT START    |
| 41     | GENERAL ELECTRIC  | GE332MAX-G-H        | 3-LAMP | INSTANT START    |
| 42     | GENERAL ELECTRIC  | GE332MV-L           | 3-LAMP | INSTANT START    |
| 43     | GENERAL ELECTRIC  | GE332MAX-N/ULTRA    | 3-LAMP | INSTANT START    |
| 44     | GENERAL ELECTRIC  | GE332MAX-G-N-DIYB   | 3-LAMP | INSTANT START    |
| 45     | GENERAL ELECTRIC  | GE432MAX-G-N        | 3-LAMP | INSTANT START    |
| 46     | GENERAL ELECTRIC  | GE332MAX-G-L        | 3-LAMP | INSTANT START    |
| 47     | GENERAL ELECTRIC  | GE332MAXP-N/ULTRA   | 3-LAMP | INSTANT START    |
| 48     | GENERAL ELECTRIC  | GE-432-MAX-L-ULTRA  | 4-LAMP | INSTANT START    |
| 49     | GENERAL ELECTRIC  | GE432MAX347-N       | 4-LAMP | INSTANT START    |
| 50     | GENERAL ELECTRIC  | GE432MVPS-H-42T     | 4-LAMP | PROGRAMMED START |
| 51     | GENERAL ELECTRIC  | GE432-MVPS-N        | 4-LAMP | INSTANT START    |
| 52     | GENERAL ELECTRIC  | GE432MAX-H/ULTRA    | 4-LAMP | INSTANT START    |
| 53     | GENERAL ELECTRIC  | GE432MAX-H-42T      | 4-LAMP | INSTANT START    |
| 54     | GENERAL ELECTRIC  | GE432-MV-N-42T      | 4-LAMP | INSTANT START    |
| 55     | GENERAL ELECTRIC  | GE-432-MV-N-42F     | 4-LAMP | INSTANT START    |
| 56     | GENERAL ELECTRIC  | GE432MV-N-DIY       | 4-LAMP | INSTANT START    |
| 57     | GENERAL ELECTRIC  | GE432MAXP-H         | 4-LAMP | INSTANT START    |
| 58     | GENERAL ELECTRIC  | GE432MAXP-N/ULTRA   | 4-LAMP | INSTANT START    |
| 59     | GENERAL ELECTRIC  | GE432-120RES-DIY    | 4-LAMP | INSTANT START    |
| 60     | GENERAL ELECTRIC  | GE432-120RES-DIYB   | 4-LAMP | INSTANT START    |
| 61     | GENERAL ELECTRIC  | GE432MAX-N/ULTRA    | 4-LAMP | INSTANT START    |
| 62     | GENERAL ELECTRIC  | GE432MAXP90-S60     | 4-LAMP | INSTANT START    |
| 63     | GENERAL ELECTRIC  | GE432MAX-G-L        | 4-LAMP | INSTANT START    |
| 64     | HALCO             | EP132IS/MV/MC       | 1-LAMP | INSTANT START    |
| 65     | HALCO             | EP332IS/H/MV/SL     | 3-LAMP | INSTANT START    |
| 66     | HALCO             | EP432IS/L/MV/HE     | 4-LAMP | INSTANT START    |
| 67     | HALCO             | EP432IS/MV/HE       | 4-LAMP | INSTANT START    |
| 68     | HOWARD            | EPH3/32IS-MV/MC/HE  | 3-LAMP | INSTANT START    |
| 69     | HOWARD            | EP4/32IS-MV/MC/HE   | 4-LAMP | INSTANT START    |
| 70     | HOWARD INDUSTRIES | EP2/32IS/MV/MC/HE   | 2-LAMP | INSTANT START    |
| 71     | HOWARD INDUSTRIES | EP3/32IS/MV/MC/HE   | 3-LAMP | INSTANT START    |
| 72     | HOWARD INDUSTRIES | EPH4/32IS/MV/SC/HE  | 4-LAMP | INSTANT START    |
| 73     | HOWARD INDUSTRIES | EP4/32IS/MV/MC/HE   | 4-LAMP | INSTANT START    |
| 74     | KEYSTONE          | KTEB-232RIS-1-TP-SL | 2-LAMP | INSTANT START    |
| 75     | KEYSTONE          | KTEB-232-UV-IS-N-P  | 2-LAMP | INSTANT START    |
| 76     | KEYSTONE          | KTEB-332-UV-IS-H-P  | 4-LAMP | INSTANT START    |



# BALLAST COMPATIBILITY LIST of TYPE A

VERSION : G

UPDATED DATE : 2017/9/01

**THE COMPATIBILITY LIST OF BELOW WAS ALL VERIFIED WITH TYPE A**

| NUMBER | BRAND OF BALLAST | PRODUCT MODEL            | OUTPUT | STARTING TYPE    |
|--------|------------------|--------------------------|--------|------------------|
| 77     | KEYSTONE         | KTEB-432-UV-IS-N-P       | 4-LAMP | INSTANT START    |
| 78     | OSRAM /SYLVANIA  | QTP 1X32T8/UNV ISU-SC    | 1-LAMP | INSTANT START    |
| 79     | OSRAM /SYLVANIA  | QHE 1X32T8/UNV ISH HT SC | 1-LAMP | INSTANT START    |
| 80     | OSRAM /SYLVANIA  | QHE 1X32T8/UNV ISL-SC    | 1-LAMP | INSTANT START    |
| 81     | OSRAM /SYLVANIA  | QHE 1X32T8/UNV ISH-SC    | 1-LAMP | INSTANT START    |
| 82     | OSRAM /SYLVANIA  | QHE 1X32T8/UNV PSN-MC    | 1-LAMP | PROGRAMMED START |
| 83     | OSRAM /SYLVANIA  | QHE 2X32T8/UNV ISH HT-SC | 2-LAMP | INSTANT START    |
| 84     | OSRAM /SYLVANIA  | QHE 2X32T8/UNV DIM-TC    | 2-LAMP | PROGRAMMED START |
| 85     | OSRAM /SYLVANIA  | QHE 3X32T8/UNV ISN-SC    | 3-LAMP | INSTANT START    |
| 86     | OSRAM /SYLVANIA  | QHE 3X32T8/UNV PSN-SC    | 3-LAMP | PROGRAMMED START |
| 87     | OSRAM /SYLVANIA  | QHE 4X32T8/UNV PSN-SC    | 4-LAMP | PROGRAMMED START |
| 88     | OSRAM /SYLVANIA  | QHE 4X32T8/UNV ISH       | 4-LAMP | INSTANT START    |
| 89     | OSRAM /SYLVANIA  | QHE 4X32T8/347 ISN-SC    | 4-LAMP | INSTANT START    |
| 90     | OSRAM SYLVANIA   | QHE 1X32T8/347 ISN-SC    | 1-LAMP | INSTANT START    |
| 91     | OSRAM SYLVANIA   | QHE 1X32T8/UNV ISN-SC    | 1-LAMP | INSTANT START    |
| 92     | OSRAM SYLVANIA   | QTP 1X32T8/UNV ISL-SC    | 1-LAMP | INSTANT START    |
| 93     | OSRAM SYLVANIA   | QT2X32T8/347 ISH-SC      | 2-LAMP | INSTANT START    |
| 94     | OSRAM SYLVANIA   | QTP 2X32T8/UNV ISN-SC    | 2-LAMP | INSTANT START    |
| 95     | OSRAM SYLVANIA   | QHE 2X32T8/UNV ISN-SC    | 2-LAMP | INSTANT START    |
| 96     | OSRAM SYLVANIA   | QHE 2X32T8/UNV ISH-SC    | 2-LAMP | INSTANT START    |
| 97     | OSRAM SYLVANIA   | QHE 2X32T8/UNV PSN-MC    | 2-LAMP | PROGRAMMED START |
| 98     | OSRAM SYLVANIA   | QHE 3X32T8/UNV ISL-SC    | 3-LAMP | INSTANT START    |
| 99     | OSRAM SYLVANIA   | QHE 3X32T8/UNV ISH-SC    | 3-LAMP | INSTANT START    |
| 100    | OSRAM SYLVANIA   | QTP 3X32T8/UNV ISH-SC    | 3-LAMP | INSTANT START    |
| 101    | OSRAM SYLVANIA   | QHE 3X32T8/UNV PSH-HT-SC | 3-LAMP | PROGRAMMED START |
| 102    | OSRAM SYLVANIA   | QTP 3X32T8/UNV ISN-SC    | 3-LAMP | INSTANT START    |
| 103    | OSRAM SYLVANIA   | QT4X32T8/347 ISN-SC      | 4-LAMP | INSTANT START    |
| 104    | OSRAM SYLVANIA   | QTP 4X32T8/UNV ISN-SC    | 4-LAMP | INSTANT START    |
| 105    | OSRAM SYLVANIA   | QHE 4X32T8/UNV ISL-SC    | 4-LAMP | INSTANT START    |
| 106    | OSRAM SYLVANIA   | QHE 4X32T8/UNV PSH-HT    | 4-LAMP | PROGRAMMED START |
| 107    | OSRAM SYLVANIA   | QHE 4X32T8/UNV ISH-SC    | 4-LAMP | INSTANT START    |
| 108    | OSRAM SYLVANIA   | QHE 4X32T8/UNV ISN-SC    | 4-LAMP | INSTANT START    |
| 109    | PHILIPS ADVANCE  | ICN-1P32-N               | 1-LAMP | INSTANT START    |
| 110    | PHILIPS ADVANCE  | IOPA-1P32-N              | 1-LAMP | INSTANT START    |
| 111    | PHILIPS ADVANCE  | REB-2P32-SC              | 2-LAMP | INSTANT START    |
| 112    | PHILIPS ADVANCE  | REL-2P32-SC              | 2-LAMP | INSTANT START    |
| 113    | PHILIPS ADVANCE  | ICN-2P32-N               | 2-LAMP | INSTANT START    |
| 114    | PHILIPS ADVANCE  | GOPA-2P32-SC             | 2-LAMP | INSTANT START    |

# BALLAST COMPATIBILITY LIST of TYPE A

VERSION : G

UPDATED DATE : 2017/9/01

**THE COMPATIBILITY LIST OF BELOW WAS ALL VERIFIED WITH TYPE A**

| NUMBER | BRAND OF BALLAST | PRODUCT MODEL        | OUTPUT | STARTING TYPE    |
|--------|------------------|----------------------|--------|------------------|
| 115    | PHILIPS ADVANCE  | IOP-2PSP32-SC        | 2-LAMP | PROGRAMMED START |
| 116    | PHILIPS ADVANCE  | ICN-2S40-N           | 2-LAMP | PROGRAMMED START |
| 117    | PHILIPS ADVANCE  | IOP-2P32HL-SC        | 2-LAMP | INSTANT START    |
| 118    | PHILIPS ADVANCE  | IOPA-2P32HL-N        | 2-LAMP | INSTANT START    |
| 119    | PHILIPS ADVANCE  | IOPA-2P32HL-SC       | 2-LAMP | INSTANT START    |
| 120    | PHILIPS ADVANCE  | IOPA-2P32-N          | 2-LAMP | INSTANT START    |
| 121    | PHILIPS ADVANCE  | IDA-2S32-SC          | 2-LAMP | PROGRAMMED START |
| 122    | PHILIPS ADVANCE  | VEL-2P32-SC          | 2-LAMP | INSTANT START    |
| 123    | PHILIPS ADVANCE  | IOPA-2P32-LW-N       | 2-LAMP | INSTANT START    |
| 124    | PHILIPS ADVANCE  | IOP-2P32-N           | 2-LAMP | INSTANT START    |
| 125    | PHILIPS ADVANCE  | ICN-3P32-N           | 3-LAMP | INSTANT START    |
| 126    | PHILIPS ADVANCE  | IOP-3PSP32-SC        | 3-LAMP | PROGRAMMED START |
| 127    | PHILIPS ADVANCE  | IOP-3PSP32-LW-SC     | 3-LAMP | PROGRAMMED START |
| 128    | PHILIPS ADVANCE  | IOPA-3P32-N          | 3-LAMP | INSTANT START    |
| 129    | PHILIPS ADVANCE  | IOP-3P32-N           | 3-LAMP | INSTANT START    |
| 130    | PHILIPS ADVANCE  | IOPA-3P32HL-SC       | 3-LAMP | INSTANT START    |
| 131    | PHILIPS ADVANCE  | ICN-4P32-SC          | 4-LAMP | INSTANT START    |
| 132    | PHILIPS ADVANCE  | ICN-4P32-N           | 4-LAMP | INSTANT START    |
| 133    | PHILIPS ADVANCE  | REB-4P32-SC          | 4-LAMP | INSTANT START    |
| 134    | PHILIPS ADVANCE  | IOPA-4P32-LW-N       | 4-LAMP | INSTANT START    |
| 135    | PHILIPS ADVANCE  | IOPA-4P32-SC         | 4-LAMP | INSTANT START    |
| 136    | PHILIPS ADVANCE  | GOPA-4P32-SC         | 4-LAMP | INSTANT START    |
| 137    | PHILIPS ADVANCE  | VEL-4P32-SC          | 4-LAMP | INSTANT START    |
| 138    | PHILIPS ADVANCE  | IOP-4P32-LW-N        | 4-LAMP | INSTANT START    |
| 139    | PHILIPS ADVANCE  | IOPA-4P32-N          | 4-LAMP | INSTANT START    |
| 140    | PHILIPS ADVANCE  | IOP-4P32-N           | 4-LAMP | INSTANT START    |
| 141    | ROBERTSON        | ISU232T8120          | 2-LAMP | INSTANT START    |
| 142    | ROBERTSON        | ISA259T8MV           | 3-LAMP | INSTANT START    |
| 143    | ROBERTSON        | ISL432T8HEMV         | 4-LAMP | INSTANT START    |
| 144    | STANDARD         | E232T8IS120-277/N/AS | 2-LAMP | INSTANT START    |
| 145    | STANDARD         | E232T8IS10/N/AS/BULK | 2-LAMP | INSTANT START    |
| 146    | STANDARD         | E432T8IS10/N/AS/BULK | 4-LAMP | INSTANT START    |
| 147    | SUNPARK          | U-2/32ISE            | 2-LAMP | INSTANT START    |
| 148    | SUNPARK          | 120-2/32IS MPF       | 2-LAMP | INSTANT START    |
| 149    | SUNPARK          | U-3/32ISE            | 3-LAMP | INSTANT START    |
| 150    | SUNPARK          | U-3/32ISE-LBF        | 3-LAMP | INSTANT START    |
| 151    | SUNPARK          | U-4/32ISE-HBF        | 4-LAMP | INSTANT START    |
| 152    | SUNPARK          | 120-4/32IS MPF       | 4-LAMP | INSTANT START    |
| 153    | ULTRASAVE        | UT 232347            | 2-LAMP | INSTANT START    |
| 154    | UNIVERSAL        | B132IUNVEL-A         | 1-LAMP | INSTANT START    |

# BALLAST COMPATIBILITY LIST of TYPE A

VERSION : G

UPDATED DATE : 2017/9/01

THE COMPATIBILITY LIST OF BELOW WAS ALL VERIFIED WITH TYPE A

| NUMBER | BRAND OF BALLAST | PRODUCT MODEL | OUTPUT | STARTING TYPE    |
|--------|------------------|---------------|--------|------------------|
| 155    | UNIVERSAL        | B132IUNVHP-N  | 1-LAMP | INSTANT START    |
| 156    | UNIVERSAL        | B132IUNVHP-B  | 1-LAMP | INSTANT START    |
| 157    | UNIVERSAL        | B232IUNVHE-A  | 2-LAMP | INSTANT START    |
| 158    | UNIVERSAL        | B232PUNVHE-B  | 2-LAMP | PROGRAMMED START |
| 159    | UNIVERSAL        | B232IUNVHP-B  | 2-LAMP | INSTANT START    |
| 160    | UNIVERSAL        | B232IUNVHP-N  | 2-LAMP | INSTANT START    |
| 161    | UNIVERSAL        | B232IUNVHEH-A | 2-LAMP | INSTANT START    |
| 162    | UNIVERSAL        | ET232120M     | 2-LAMP | INSTANT START    |
| 163    | UNIVERSAL        | B259IUNVHP-A  | 2-LAMP | INSTANT START    |
| 164    | UNIVERSAL        | B232I347HP-A  | 2-LAMP | INSTANT START    |
| 165    | UNIVERSAL        | B232IUNVEL-A  | 3-LAMP | INSTANT START    |
| 166    | UNIVERSAL        | B332IUNVHE-A  | 3-LAMP | INSTANT START    |
| 167    | UNIVERSAL        | B232IUNVHP-A  | 3-LAMP | INSTANT START    |
| 168    | UNIVERSAL        | B332IUNVHP-A  | 3-LAMP | INSTANT START    |
| 169    | UNIVERSAL        | B432IUNVHE-A  | 4-LAMP | INSTANT START    |
| 170    | UNIVERSAL        | B432IUNVEL-A  | 4-LAMP | INSTANT START    |
| 171    | UNIVERSAL        | B432I347HP    | 4-LAMP | INSTANT START    |
| 172    | UNIVERSAL        | B432I347HPL   | 4-LAMP | INSTANT START    |
| 173    | UNIVERSAL        | B432IUNVHP-A  | 4-LAMP | INSTANT START    |

\*Updated 14 new compatible models marked in red wording

- Note:
- 1. The ballasts model list on the chart have been test and already get approved by manufacturer;**
  - 2. Absence of a ballast from this chart does not imply incompatibility. Please reference the ballast manufacturer's instructions for installation and further information.**
  - 3. This list is to be used as a general guideline, the LED tube may not work if the ballast is over 5 years old or have a weak starting voltage.**
  - 4. Please strictly follow the wiring diagram shown on the ballasts;**
  - 5. Please check if the contact points of the old fixture work normal**
  - 6. Please use caution and test lamps in fixtures for an extended period of time to ensure proper operation ;**
  - 7. Do not proceed with a mass installation until proper operation of the LED tube is verified.**
  - 8. We will continuously testing new model ballasts in lab, pls contact manufacturer to get latest compatibility list;**