



JOB NAME:

CAT#:

TYPE:

APPLICATIONS

The LHBIP LED is a high efficiency I-Beam style high bay fixture engineered for high performance. A precision-formed silver reflector is designed to achieve maximum light output for ceilings from 15 feet to 40 feet. Based on ceiling height, these fixtures can replace a fluorescent or traditional HID high bay while using up to 50% less energy. Surface or chain mounting systems are available. The fixture is ideally suited for warehouses, manufacturing plants, sports facilities, and retail spaces.

Housing is 22 gauge prepainted steel. Air vents surround the drivers in the back of the fixture to maximize LED and driver performance, reliability and life. Highly efficient reflectors are computer designed to maximize photometric performance and put the light where you need it. Back access plate allows for fast and hassle-free wiring. Back of fixture is designed with built-in mounting holes for tong hangers, cable kit, or surface mounting (with additional brackets). Chain kit included. 5 year limited system warranty. ETL Listed.

Designed for surface or chain hanging. Mounting holes are provided for simple fast installation. Chain kit included.

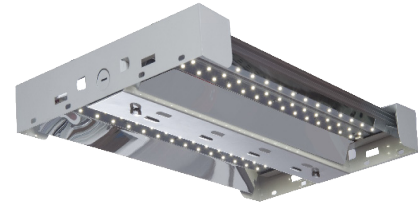

FEATURES & BENEFITS

- 22 Gauge White Steel Vented Housing
- Chain kit included
- Environmentally Friendly - Mercury Free
- Rated at 50,000 hrs of L₇₀ Life
- RoHS Compliant
- 5 Year Limited Warranty
- High Power Factor
- L₇₀>50,000 hrs; L₉₀>36,000 hrs
- cETL_{us} Listed

DIMENSIONS

A-LHB1x2WG:

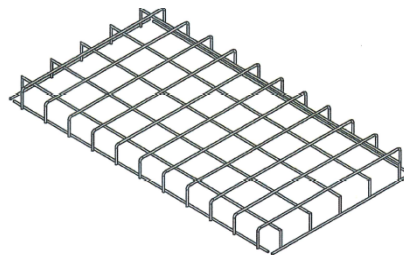
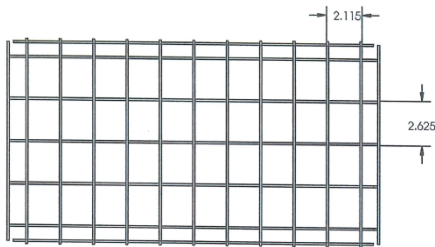

- 110W - 11.80W x 21.50L x 2.00H
- 170W - 16.00W x 21.50L x 2.00H
- 230W - 11.80W x 43.00L x 2.00H
- 245W - 20.00W x 43.00L x 1.50H
- 320W - 20.00W x 43.00L x 1.50H

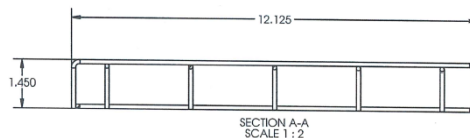
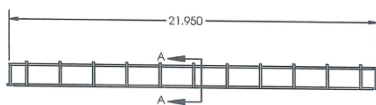

Dimensions and specifications subject to change without notice.





JOB NAME:

CAT#:

TYPE:

DIMENSIONS

A-LHBIP2x4WG:

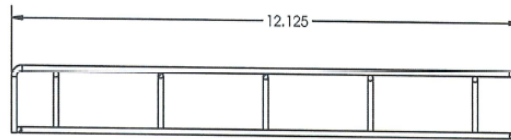
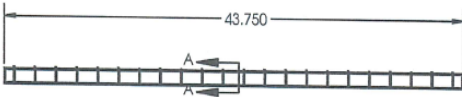
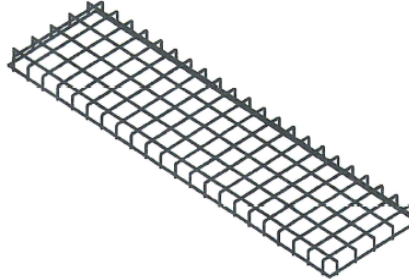

SECTION A-A
SCALE 1:2

A-LHBIP2x2WG:

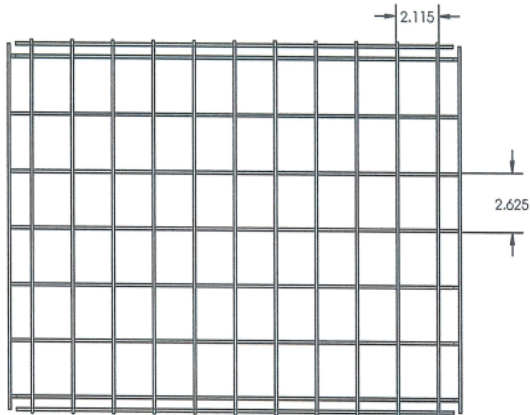

SCALE 1:4

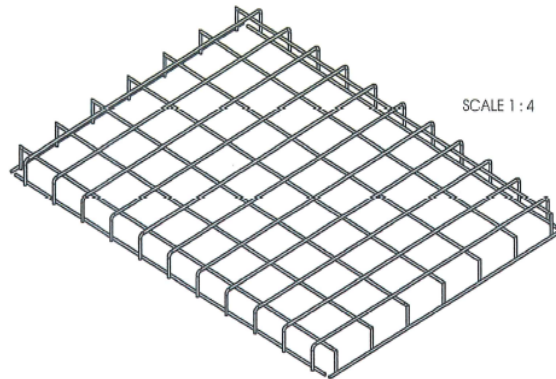

SCALE 1:4

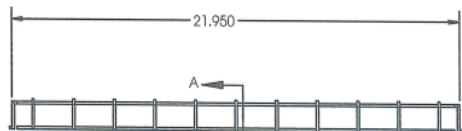

SCALE 1:4

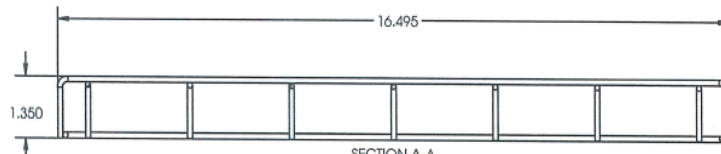

SECTION A-A
SCALE 1:2

Dimensions and specifications subject to change without notice.





JOB NAME:

CAT#:

TYPE:

ORDERING

EXAMPLE: LHBIP LED 110 MV 40 EM OS

LHBIP	LED										
1. SERIES	2. GEAR	3. WATTAGE/LUMENS		4. DRIVER		5. COLOR TEMP		6. EMERGENCY(O) ²		6. SENSOR(O) ²	
LHBIP	LED	110	110 Watts 14,680 Lumens	MV	120-277V	40	4000K	EM	10 Watt Emergency Pack	OS	Occupancy Sensor
		170	170 Watts 22,020 Lumens	DMV	120-277VAC 0-10V Dimmable ¹	50	5000K				
		230	230 Watts 29,370 Lumens Premium								
		200	200 Watts 27,820 Lumens								
		240	240 Watts 33,380 Lumens								
		320	320 Watts 45,500 Lumens								

**See chart below for whip & cord ordering options

**Cord & Whip Ordering Chart (Add to End of Fixture Part Number)						
Part No.	# of Wires	Length	End Fitting	Finish	Voltage	Amps (TL Only)
WP - Whip CS - Cordset	(Blank) 3 Wire 4 - 4 Wire 5 - 5 Wire 6 - 6 Wire	(Blank) 6 feet 8 - 8 feet 10 - 10 feet 12 - 12 feet 15 - 15 feet	(Blank) No Plug P* - Standard Plug TL* - Twist Lock	BK - Black WH - White	(Blank) 120-277V 120 - 120V 277 - 277V 347 - 347V 480 - 480V	15 - 15 Amps 20 - 20 Amps

NOTES:

¹Premium Only
²O is optional

DLC Standard	
LHBIP-LED110MVxx	xx = Color Temp 40, 50
LHBIP-LED170MVxx	xx = Color Temp 40, 50
LHBIP-LED230MVxx	xx = Color Temp 40, 50
DLC Premium	
LHBIP-LED200DMVxx	xx = Color Temp 40, 50
LHBIP-LED240DMVxx	xx = Color Temp 40, 50
LHBIP-LED320DMVxx	xx = Color Temp 40, 50

Dimensions and specifications subject to change without notice.





JOB NAME:

CAT#:

TYPE:

ACCESSORIES

110W Accessories	
FL-LHBI 1X2-MW	1X2 High Bay Door Frame Set w/ Matte white lens
A-LHBI 1X2-WG	1X2 Wire Guard white
A-LHBIFMK	Flush Mounting Kit 6"L x 2"W x .8"H
A-LHBIPMK	Pendant Mounting Kit 3.4"L x 2.3"W x 2"H
170W Accessories	
FL-LHBI 2X2-MW	2X2 High Bay Door Frame Set w/ Matte white lens
FL-LHBI 2X2-WG	2X2 Wire Guard white
A-LHBIFMK	Flush Mounting Kit 6"L x 2"W x .8"H
A-LHBIPMK	Pendant Mounting Kit 3.4"L x 2.3"W x 2"H
230W Accessories	
FL-LHBI 2X4-MW	2X4 High Bay Door Frame Set w/ Matte white lens
A-LHBI 2X4-WG	2X4 Wire Guard white
A-LHBIFMK	Flush Mounting Kit 6"L x 2"W x .8"H
A-LHBIPMK	Pendant Mounting Kit 3.4"L x 2.3"W x 2"H
200W, 240W and 320W Accessories	
A-LHBIPMK-HO	Pendant mounting kit for LHBIP High Output LED High Bay

Dimensions and specifications subject to change without notice.

