



Project Details

PROJECT	
PRODUCT	
TYPE	
PREPARER	



A wall pack is well known for keeping a building’s perimeter illuminated and also for providing security lighting. Nebulite’s WPG series wall pack is suitable for wet and damp locations (Weatherproof IP65) and has a button photocell sensor to automatically turn on at night and off during the day for increased efficiency. It is a great choice for outdoor lighting that has an L70 Lifespan of 100,000 hours. Made from durable, corrosion-resistant aluminum housings and a great LED design ensures a long-lasting life and reduces the need for costly maintenance. Like most of our products, the WPG series wall pack is backed by Nebulite’s 7 year warranty and is UL & DLC listed.

SPECIFICATIONS Product Features

Construction

- Die-cast Aluminum Housing
- Prismatic Glass Lens
- 6KV Surge Protection
- Four NPT Half Inch Knock Outs

Installation & Mounting

- Luminaire mounting designed for standard J-Box. Can be mounted directly to surface. Features multiple conduit entries

Controls & Dimming

- 0-10 Volt Dimming
- 12V AUX
- 90 Mins Emergency Battery Back-up
- Build-in Daylight Sensor

PERFORMANCE Summary

Input Voltage	100-277V
Input Frequency	50/60 Hz
Rated Wattage	40W-50W-60W (<i>Selectable</i>) 80W-100W-120W (<i>Selectable</i>)
Efficacy	145 lm/W
CRI	>80
Available CCT	3500K, 4000K, 5000K (<i>Selectable</i>)
Rated Life (L70)	100,000 hrs
IP Rating	IP65
PF	>0.9
Certifications	DLC, CE, RoHS, UL, FCC
Working Temp. (°F)	-40°F - 125°F
LED Light Source	SMD 2835



BEAM Angle

MERIDIAN SURFACE LIGHT DISTRIBUTION CURVE

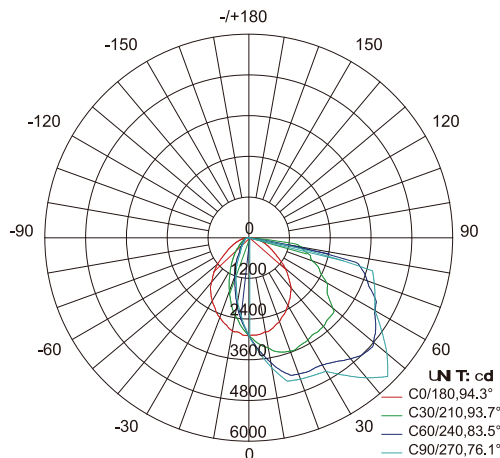

AVERAGE BEAM ANGLE(50%):86.9 DEGREE

LIGHT INTENSITY DISTRIBUTION CURVE OF CONICAL SURFACE AT MAXIMUM LIGHT INTENSITY

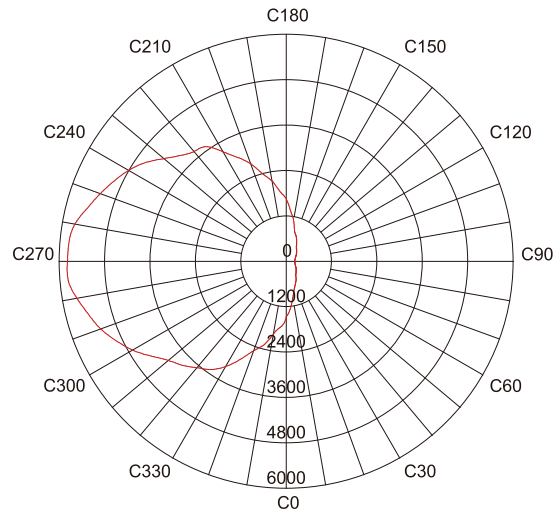

ROOF MAXIMUM POSITION Y=45.0° ROADSIDE

PERFORMANCE Data

MODEL	WATTAGE	CCT	LUMEN	EFFICACY (lm/W)	VOLTAGE
NB-WPG-40	40watt	3500K, 4000K, 5000K	5,800lm	145 lm/W	100-277vac
NB-WPG-50	50watt	3500K, 4000K, 5000K	7,250lm	145 lm/W	100-277vac
NB-WPG-60	60watt	3500K, 4000K, 5000K	8,700lm	145 lm/W	100-277vac
NB-WPG-80	80watt	3500K, 4000K, 5000K	11,600lm	145 lm/W	100-277vac
NB-WPG-100	100watt	3500K, 4000K, 5000K	14,500lm	145 lm/W	100-277vac
NB-WPG-120	120watt	3500K, 4000K, 5000K	17,400lm	145 lm/W	100-277vac

*Lumen data based on by 5000K

ORDER Data

Sample: **NB-WPG-120W**

SERIES	WATTAGE	CCT	VOLTAGE	OPTICS	FINISH*
NB-WPG	40W-50W-60W	35 = 3500K 40 = 4000K 50 = 5000K	BLANK =100-277V	FORWARD	BLANK = Bronze WH = White BLK = Black SVL = Silver
	80W-100W-120W				

* contact the Nebulite sales team for turnaround time and pricing on finish color customizations

MOUNTING | OPTIONAL functions

JB	WM	EM5	EM12	PC	CF
Standard J-Box	Wall Mount	Emergency Battery Back-up (5W)	Emergency Battery Back-up (12w)	Daylight Sensor	Custom Finish

DIMENSIONS

50 Watt - 150 Watt

INCHES

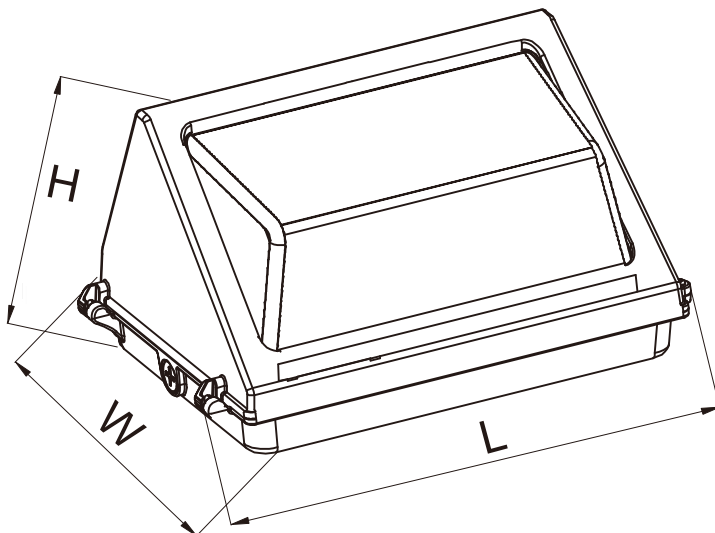

40-50-60W	L 14.21*W 9.29* H 7.6inch
80-100-120W	

INSTALLATION

Junction Box Mounting:

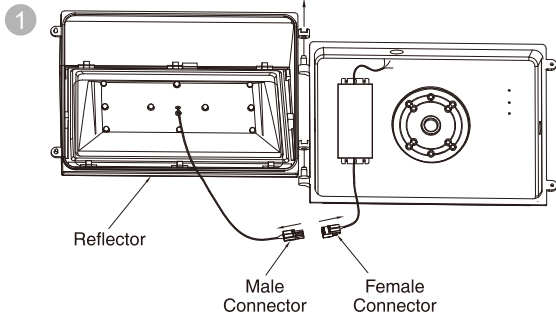

1. Unscrew the screws on the right side using a suitable screwdriver. Separate the male and female connectors, then remove the reflector from the back plate.

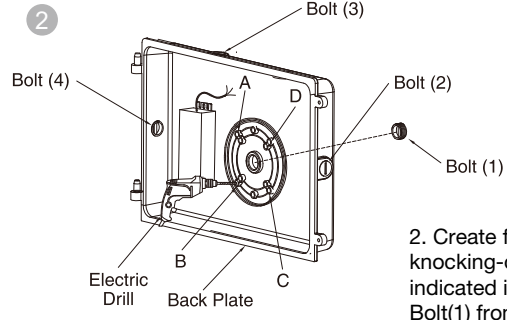

2. Create four 0.2inch holes by knocking-out the four points indicated in A/B/C/D. Unscrew Bolt(1) from the bottom center. (Note: the other three Bolts (2)/(3)/(4) can be unscrewed depending on your requirements during the wiring process.)

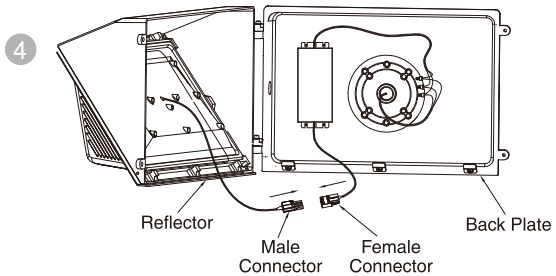

4. Use the hinge to lock the reflector to the back plate firmly, then connect the main power. Black wiring to L, White to N, Green to G (see diagram above.) Next, connect the male and female connectors together. Finally, use a suitable screwdriver to connect the reflector to the back plate.

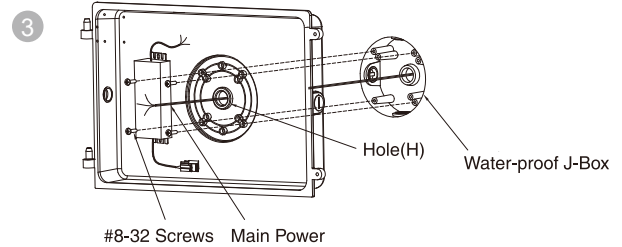

3. Run the main power wire from the water-proof J-box through the hole(H), then lock the back plate to the waterproof J-box using four #8-32 screws.

Conduit Mounting:

1. Unscrew the screws on the right side using a suitable screwdriver. Separate the male and female connectors, then remove the reflector from the back plate.

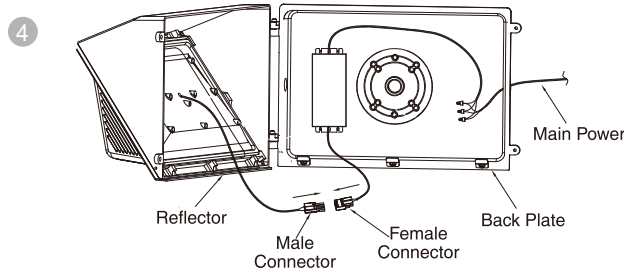

4. Use the hinge to lock the reflector to the back plate firmly. Next, connect the male and female connectors together. Finally, use a suitable screwdriver to connect the reflector to the back plate.

2. Unscrew the right-side Bolt(5). Open the three 0.26inch holes in E/F/G by a suitable drill, and then fasten the back plate to the wall with the three screw components. (Make sure the open holes-E/F/G are waterproof)

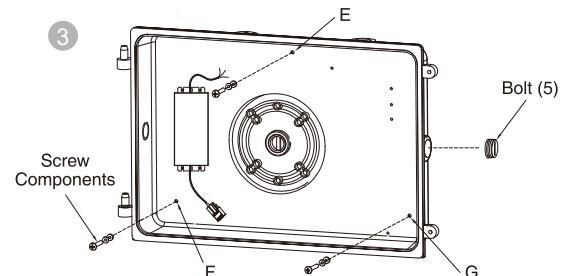

3. Run the main power through the right hole and then finish the wiring (Black wire - L, White wire -N, Green wire - G)

LED Emergency Back-Up Driver | Standard Side Exit Wire Leads | 5W Output

Driver Type	Constant Wattage LED Emergency
Max. Output Power	5W
Input Voltage	120-277 Vac \pm 10%
Output Voltage	20 ~ 54Vdc
Output Current	250 - 100mA
Warranty	5 Years



PRODUCT Features

- Drives LED loads at 5W (nominal) for a minimum of 90 minutes
- Meets FCC Part 15 (Class B) consumer limits
- Short circuit overload and open load protection
- Suitable for dry and damp locations
- Evaluated to UL 924 standards
- Operating temperature: 0°C/32°F to 50°C/122°F
- Input frequency: 50/60 Hz
- Test switch/Charging indicator light
- Battery pack with quick connect: NiCd
- Battery capacity: 1200mAh
- Listed for field or factory installation: UL 924 and CSA C22.2 no. 141 emergency lighting compliant
- 3A max. pass-through current

Emergency Pack does not meet CEC T20 requirements. Not to be sold or offered for sale in California, except when sold wholesale in California for final retail sale outside the state.

Electrical Specifications

Family	INPUT CHARACTERISTICS			OUTPUT CHARACTERISTICS		
	Input Voltage	Power Factor	Max. Current	Max. Output Power	Rated Output Current	Output Voltage
5W	120-277Vac	\geq 0.5	0.051A @ 120V	5W	250mA-100mA	20~54Vdc

Emergency pack designed to deliver 5W to a constant current LED load. Approximate output is 500 lumens, assuming a nominal minimum efficacy of 100 lm/W

PHYSICAL Specifications

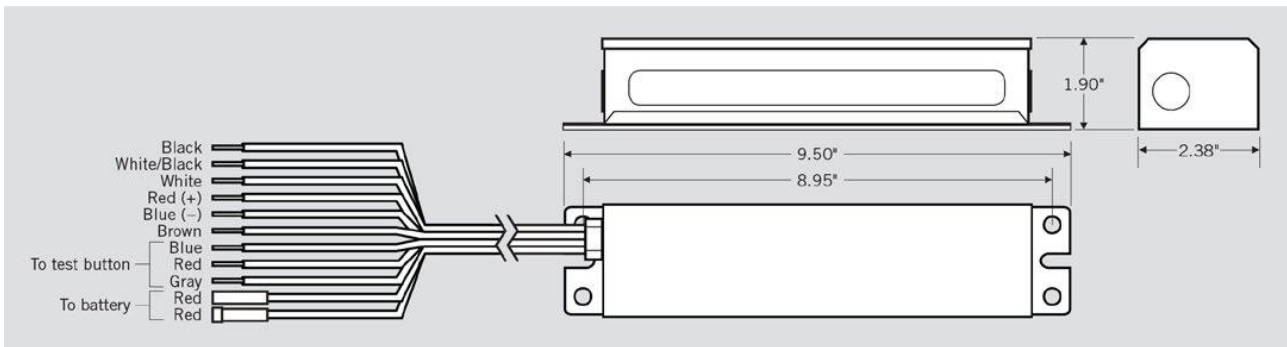

WIRING Specifications

