



Project Details

PROJECT	
DATE	
TYPE	
PREPARER	



The Field Fit LED Troffer delivers soft, glare-free, ambient lighting in a popular center-basket design. The slim profile of the fixture coupled with energy-saving LED technology make the NBRT an ideal choice for renovation or new construction applications. The LED troffer offers a high-quality, cost-effective LED lighting solution for schools, offices, retail, healthcare facilities and other commercial spaces.

SPECIFICATIONS Product Features

Construction

- Galvanized steel body
- Reflective Powder Coat white finish
- Polycarbonate hard formed lens
- Designed for easy T-Bar drop in

Installation & Mounting

- Recessed/Ceiling T-Bar

Controls & Dimming

- 0-10 Volt Dimming
- 12 Volt AUX
- Bluetooth Mesh Control (Avi-on)
- Emergency Kits
- Microwave Sensor

PERFORMANCE Summary

Input Voltage	100-277V
Input Frequency	50/60 Hz
Rated Wattage	2x2 - 20W-24W-36W (<i>Selectable</i>) 2x4 - 36W-42W-50W (<i>Selectable</i>) 2x4 NEW - 24W-36W-42W (<i>Selectable</i>)
Efficacy	130lm/W
CRI	84
Available CCT	3500K, 4000K, 5000K (<i>Selectable</i>)
Rated Life (L70)	100,000 hrs
IP Rating	IP20
PF	>0.95
Certifications	ETL, DLC Premium, CE, RoHS
Working Temp. (°F)	-4°F ~ 104°F
LED Light Source	SMD 2835



TESTING Report

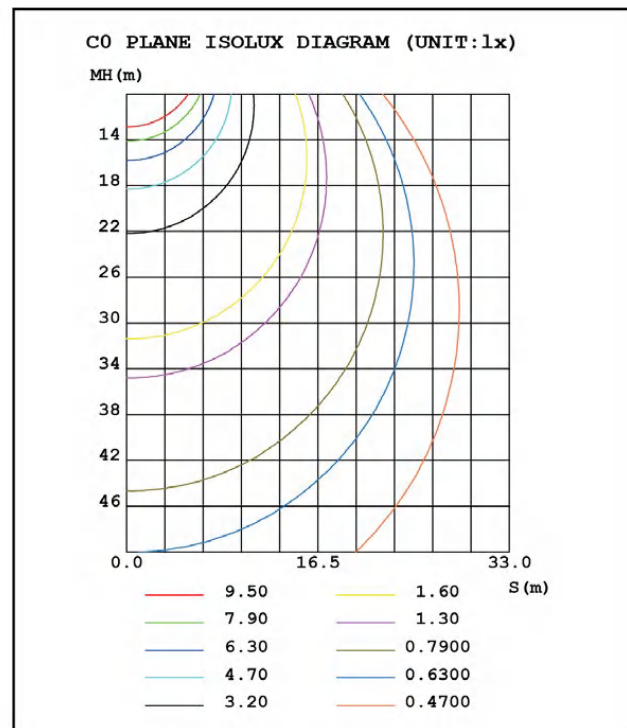
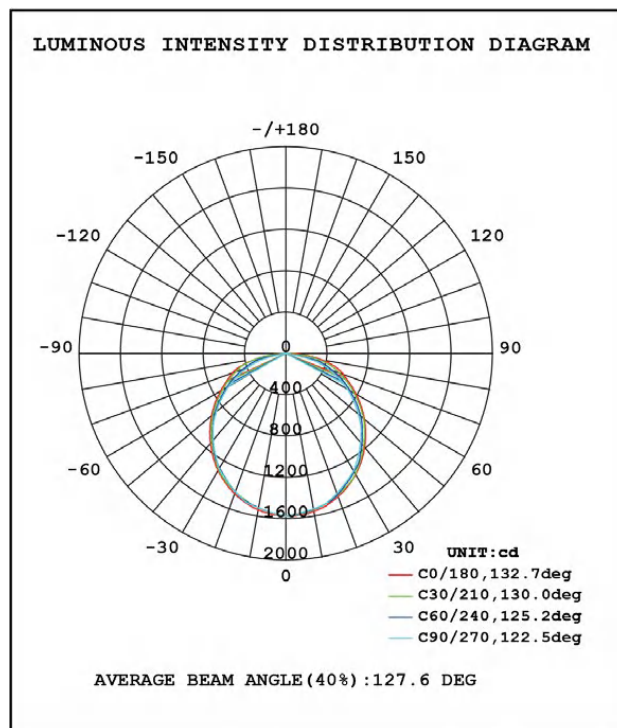

PRODUCT DIMENSIONS

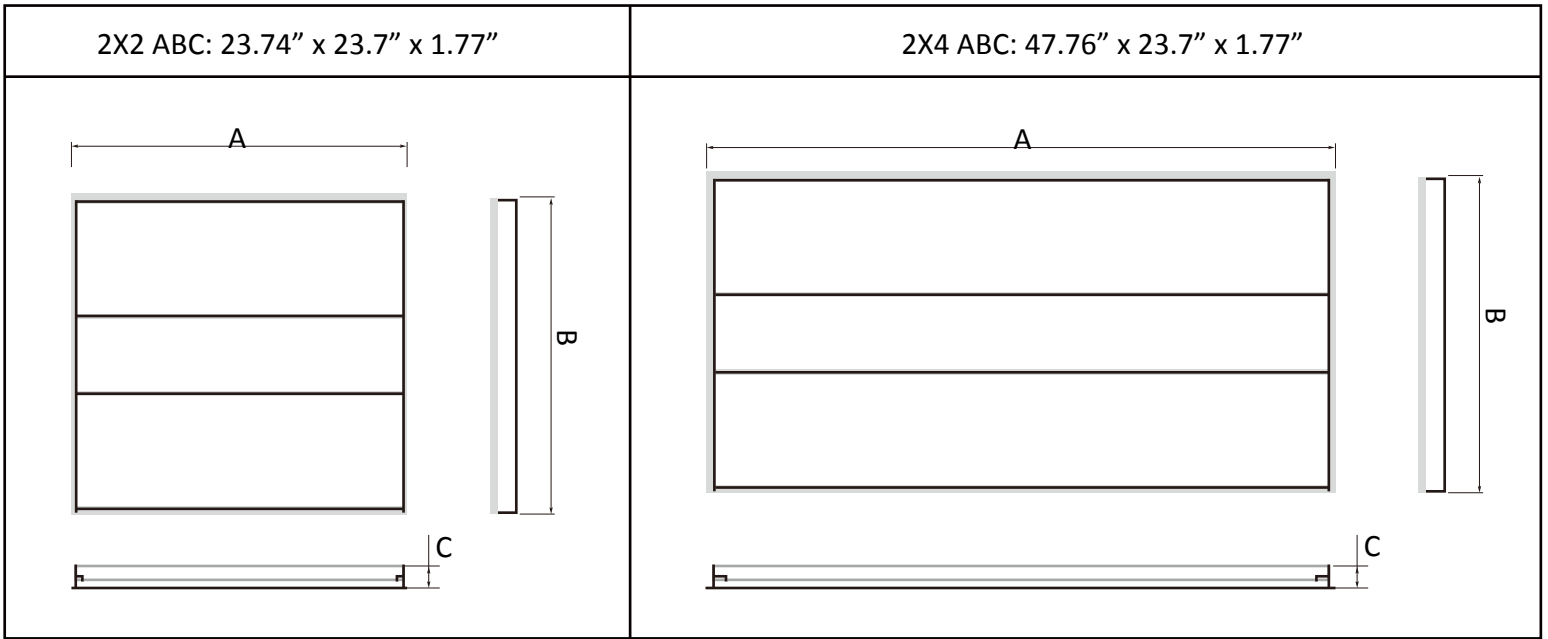

PRODUCT DIMENSIONS

2X2 Troffer:

Wattage: 20W-24W-36W
 3 Channels Option
 CCT: 3500K/4000K/5000K

2X4 Troffer:

Wattage: 36W-42W-50W
 3 Channels Option
 CCT: 3500K/4000K/5000K

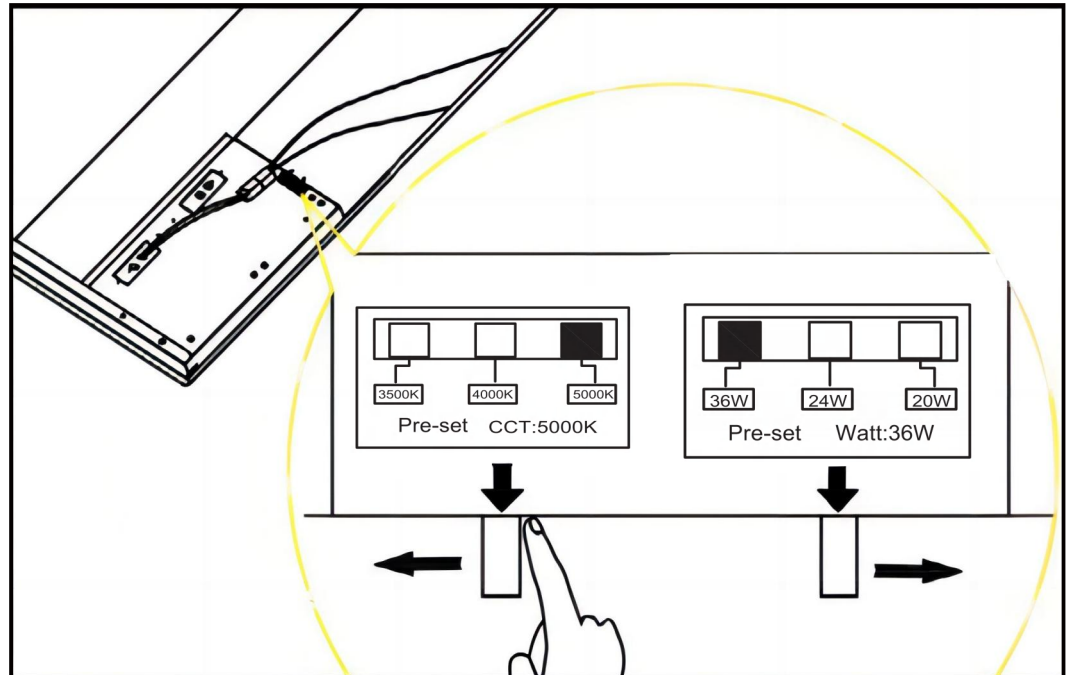

SPECIFICATIONS

MODEL	WATTS	LIGHT EFFICIENCY	LUMEN	CRI	PF	VOLTAGE	DLC
NBRT-22-20W-24W-36W 35K, 40K, 50K	20W 24W 36W	130LPW	2,600lm 3,120lm 4,680lm	84	>0.95	120-277V	PREMIUM
NBRT-22-20W 35K, 40K, 50K	20W	130LPW	2,600lm	84	>0.95	120-277V	PREMIUM
NBRT-22-24W 35K, 40K, 50K	24W	130LPW	3,120lm	84	>0.95	120-277V	PREMIUM
NBRT-22-36W 35K, 40K, 50K	36W	130LPW	4,680lm	84	>0.95	120-277V	PREMIUM
NBRT-24-24W-36W-42W 35K, 40K, 50K	24W 36W 42W	130LPW	3,120lm 4,680lm 5,460lm 6,500lm	84	>0.95	120-277V	PREMIUM
NBRT-24-24W 35K, 40K, 50K	24W	130LPW	3,120lm	84	>0.95	120-277V	PREMIUM
NBRT-24-36W 35K, 40K, 50K	36W	130LPW	4,680lm	84	>0.95	120-277V	PREMIUM
NBRT-24-42W 35K, 40K, 50K	42W	130LPW	5,460lm	84	>0.95	120-277V	PREMIUM

*Lumen output based off 5,000K model.

ORDERING Format

Sample: **NBRT-22-25W-TSMK22-EM**

SERIES	WATTAGE	CCT	VOLTAGE	Options	
NBRT-22	20W-24W-36W	35 = 3500K 40 = 4000K 50 = 5000K	BLANK = 100-277V	EMB	EM Bracket
NBRT-24	36W-42W-50W			EM	Battery Backup
NBRT-24 <i>NEW</i>	24W-36W-42W			AC	Aircraft Cable

BI-LEVEL Daylight Harvest Microwave Sensor - ANT-7 Instruction

RC-100
(OPTIONAL)



ANT-7

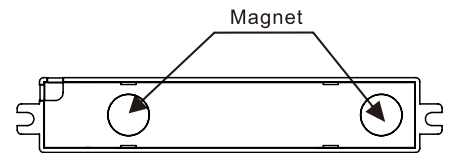
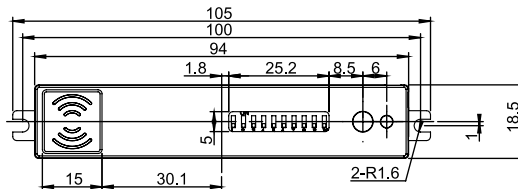

DAYLIGHT Harvesting Function (only by using RC100 remote control)

Open the daylight harvesting function only by choosing "☞" button when remote control is in setting condition. Memory and maintain current ambient brightness.

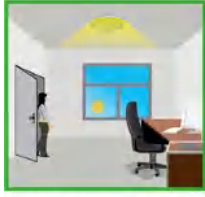

When the natural light is sufficient or dark, movement is detected and the light will turn on 100% brightness.



The light turns on at full or dims to maintain the lux level. The light output regulates according to the level of natural light available.



The light dims to stand-by period after hold-time and stays on selected minimum dimming level.

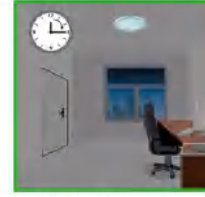

The light switches off completely after the stand-by period.

Setting on this demonstration:
 BRIGHTNESS: 100%
 SENSITIVITY: 100%
 HOLD TIME: 30MIN
 DAYLIGHT SENSOR: ☞
 STAND BY DIM: 30%
 STAND BY TIME: 1MIN

SENSOR Coverage

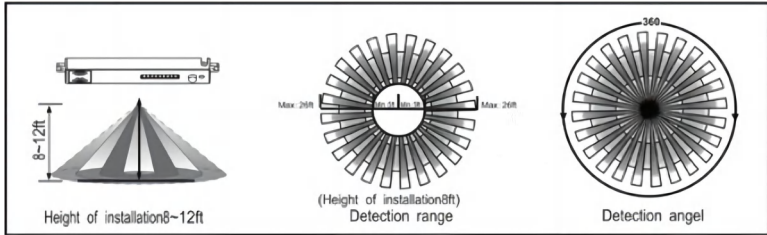

NOTE:

The high-frequency output of this sensor is <math><0.2\text{mW}</math> - that is just one 5000th of the transmission power of a mobile phone or the output of a microwave oven.

⚠ WARNING

NOTE: Warm up time is 15 seconds. After the sensor connects input power first time, the light will stay on 15 seconds, then start dimming.

NOTE: Factory Default Setting: 100% sensitivity, Hold on time: 10 seconds, Daylight sensor is 30lux, Dimming level: 30%
 Dimming time: 60 minutes

NOTE: Any setting changed by DIP Switch or remote control, the LED light that sensor connect will on/off as confirm.

SENSOR Coverage

Power Supply	12-24V DC, >50mA
HF System	5.8GHz±75MHz
Dim Control Output	0-10V, max. 25mA sinking current
Detection Radius/Angle	Max 17ft. (5.2m)/360°
Mounting Height	Max 13ft. (4m)
Remote Range	50ft. (15m) indoor, no backlight
Humidity	Max. 95% RH
Temperature	-40°F - 158°F (-40°C - 70°C)

UTILIZING Field and Introduction

ANT-7 is a moving object sensor that can detect range of 360° and its working frequency is 5.8GHz. The advantage of this product is stable working state (stable working temperature: -40°C—+70°C), ANT-7 adopts a microwave sensor (high-frequency output <math><0.2\text{mW}</math>) so that it is safe and performs better than infrared sensor.

KT-EMRG-LED-5C-500-EN /DF Constant Wattage Led Emergency Back-up

LED Emergency Back-up Driver | Dual Flex Conduit | 5W Output | 120-277V Input

Driver Type	Constant Wattage LED Emergency
Max. Output Power	12W
Input Voltage	120-277 Vac ±10%
Output Voltage	20 ~ 60 Vdc
Output Current	250 - 86 mA
Warranty	5 Years



PRODUCT Features

- Drives LED loads at 5W (nominal) for a minimum of 90 minutes
- Meets FCC Part 15 (Class B) consumer limits
- Short circuit overload and open load protection
- Suitable for dry and damp locations
- Safety Standard: UL 924, Complies with CEC Title 20 Efficiency Standards
- Operating temperature: 0°C/32°F to 50°C/131°F

- Input frequency: 50/60 Hz
- Test switch/Charging indicator light and wall plate included
- Battery capacity: High-Temperature, Maintenance-Free, LiFePO4 Battery, 9.6Vdc, 3 cell
- Dual flex conduit fits into ½" knockouts
- Listed for field or factory installation: UL 924 and CSA C22.2 no. 141 emergency lighting compliant
- 3A max. pass-through current

ELECTRICAL Specifications

Family	INPUT CHARACTERISTICS			OUTPUT CHARACTERISTICS		
	Input Voltage	Power Factor	Max. Current	Max. Output Power	Rated Output Current	Output Voltage
5W	120-277Vac	≥0.5	0.050A @ 120V 0.035A @ 240V 0.030A @ 277V	5W	250mA-86mA	20~60Vdc Class 2 Compliant

Emergency pack designed to deliver 5W to a constant current LED load. Approximate output is 500 lumens, assuming a nominal minimum efficacy of 100 lm/W.

KT-EMRG-LED-12-1200-EN /DF Constant Wattage Led Emergency Back-up

LED Emergency Back-up Driver | Dual Flex Conduit | 12W Output | 120-277V Input

Driver Type	Constant Wattage LED Emergency
Max. Output Power	12W
Input Voltage	120-277 Vac ±10%
Output Voltage	20 ~ 54 Vdc
Output Current	550 - 225 Vdc
Warranty	5 Years



PRODUCT Features

- Drives LED loads at 12W (nominal) for a minimum of 90 minutes
- Meets FCC Part 15 (Class B) consumer limits
- Short circuit overload and open load protection
- Suitable for dry and damp locations
- Evaluated to UL 924 standards
- Operating temperature: 0°C/32°F to 50°C/122°F

- Input frequency: 50/60 Hz
- Test switch/Charging indicator light and wall plate included
- Battery capacity: 3000mAh; NiCd
- Dual flex conduit fits into ½" knockouts
- Listed for field or factory installation: UL 924 and CSA C22.2 no. 141 emergency lighting compliant
- 3A max. pass-through current

Emergency Pack does not meet CEC T20 requirements. Not to be sold or offered for sale in California, except when sold wholesale in California for final retail sale outside the state.

ELECTRICAL Specifications

Family	INPUT CHARACTERISTICS			OUTPUT CHARACTERISTICS		
	Input Voltage	Power Factor	Max. Current	Max. Output Power	Rated Output Current	Output Voltage
12W	120-277Vac	≥0.5	0.050A @ 120V	12W	550mA-224mA	20~54Vdc

Emergency pack designed to deliver 12W to a constant current LED load. Approximate output is 1200 lumens, assuming a nominal minimum efficacy of 100 lm/W

PHYSICAL Specifications

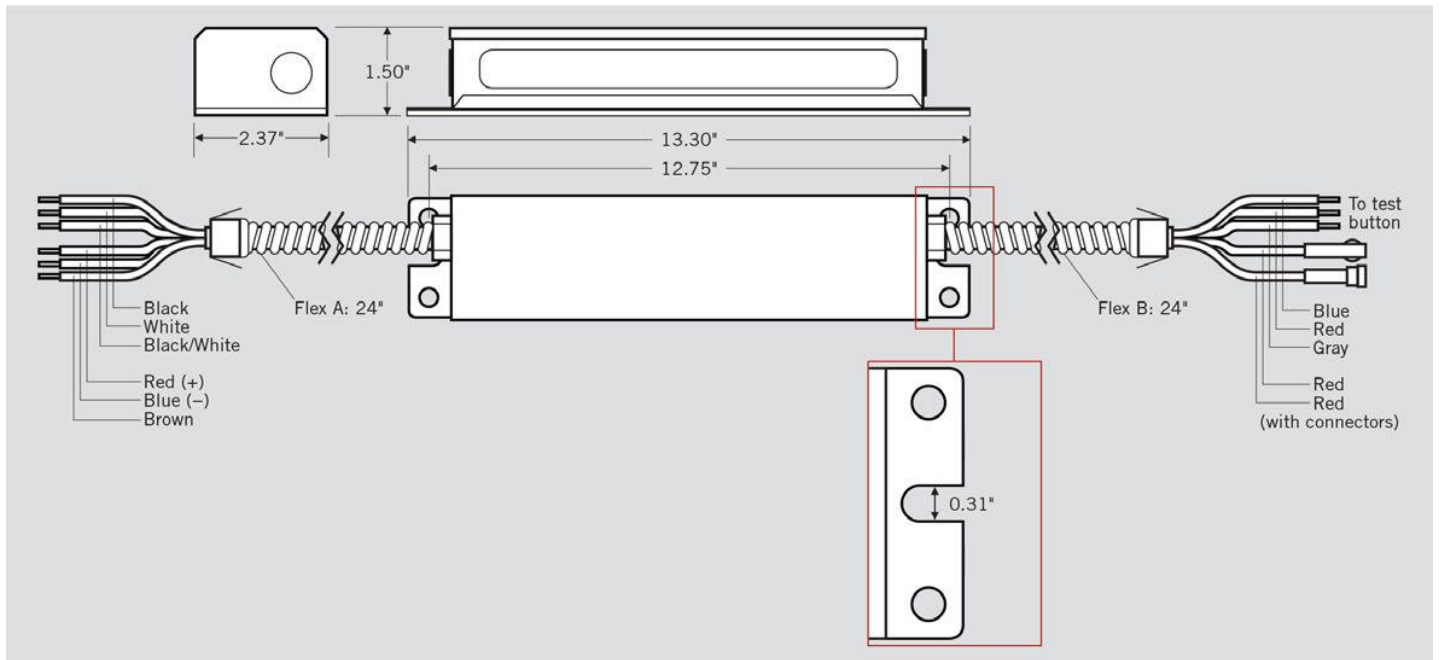

KT-EMRG-LED-12-1200-EN /DF Constant Wattage Led Emergency Back-up

