

| | |
|------------|-------|
| Catalog #: | |
| Project : | |
| Type : | Date: |
| Notes: | |

LED FLAT DISK PANEL LIGHT

TL-FDPL1™ SERIES

DESCRIPTION

Ultra-Slim Downlight Retrofit engineered for demanding commercial applications. Save up to 80% in energy cost. 100% Mercury & Lead Free.

APPLICATIONS

Ideal for lighting malls, hospitals, hotels, and retail spaces. Replaces CFL & HID or Incandescent downlights for higher energy savings & aesthetics.



QUICK SHIP:

- TL-FDPL1-7-9W-40K TL-FDPL1-7-9W-50K
- TL-FDPL1-9-18W-40K TL-FDPL1-9-18W-50K
- TL-FDPL1-9-13W-40K TL-FDPL1-9-13W-50K
- TL-FDPL1-12-24W-40K TL-FDPL1-12-24W-50K









Specification Features

Controls / Dimming

High quality internal driver; Triac dimming; Flicker free. Frosted Lens and Non-IC, and rated for damp locations. SMD2835. Beam angle is 120°.

Warranty

5 Years Limited Warranty. See warranty documentation for more information.

Certification

It complies with ETL/ cETL certification, Energy Star Rated, and FCC.

Installation / Mounting

LED recessed downlight retrofit is supplied with a quick connect-case and conduit to make an easy connection to an existing recessed fixture frame junction box. Beam angle is 120°. Instant start w/NO humming.

Ordering Information

Example: TL-FDPL1-7-6W-40K

| TL | FDPL1 | 7 | 12W | 50K | [BLANK] |
|------------------------|---------------------------------------|-------------------|--|--------------------------------------|----------------------------|
| Brand | Series | Diameter | Nominal Wattage | Color Temp | Diffuser Type |
| TL TechnoLED | FDPL1 Flat Disk Panel Light | 7 7 Inch | 6W 6 Watt | 40K 4000K 50K 5000K | [Blank] Frosted |
| | | 8 8.8 Inch | 12W 12 Watt | | |
| | | 12 12 Inch | 18W 18 Watt 24W 24 Watt | | |
| | | | | | [Blank] 110-120V |

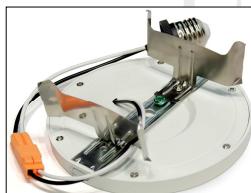

Lighting Parameters

| | |
|---------------------|---------------|
| Input Voltage | AC120V |
| CCT | 4000K / 5000K |
| CRI | Ra>80 |
| Luminous efficacy | 80 lm/w |
| PF | 0.90 |
| Driver Efficiency | 87% |
| THD | 20% |
| Working temperature | -4°F~104°F |
| Storage temperature | -22°F~140°F |
| IP Rating | IP20 |

| Part Number | L | W | H |
|-----------------|------|------|------|
| TL-FDPL1-7-9W | 5.5" | 5.5" | 0.7" |
| TL-FDPL1-9-13W | 7.3" | 7.3" | 0.7" |
| TL-FDPL1-9-18W | 9.0" | 9.0" | 0.7" |
| TL-FDPL1-12-24W | 12" | 12" | 0.7" |

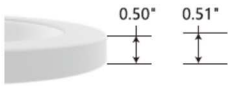

Product Dimension

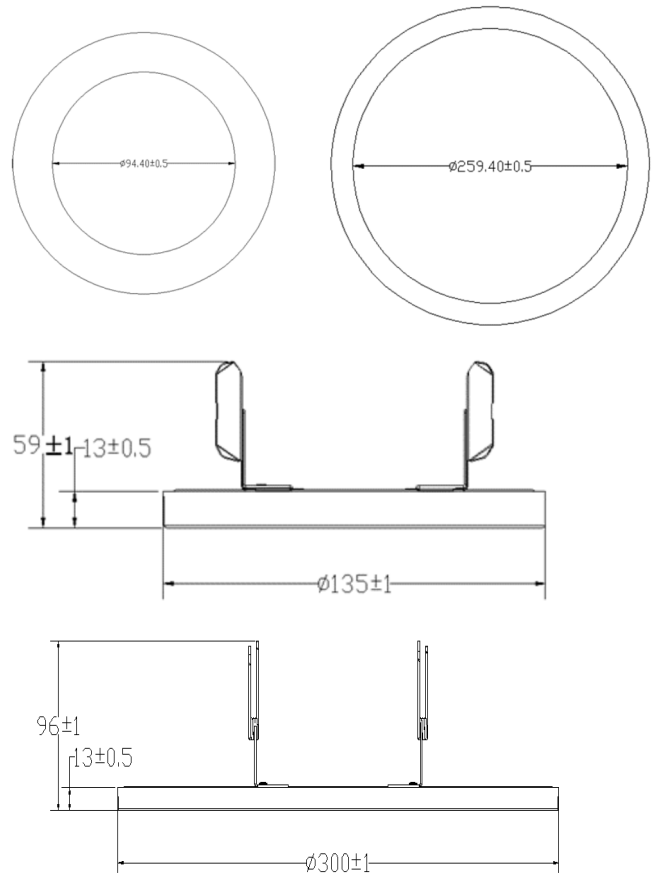

Photometric data

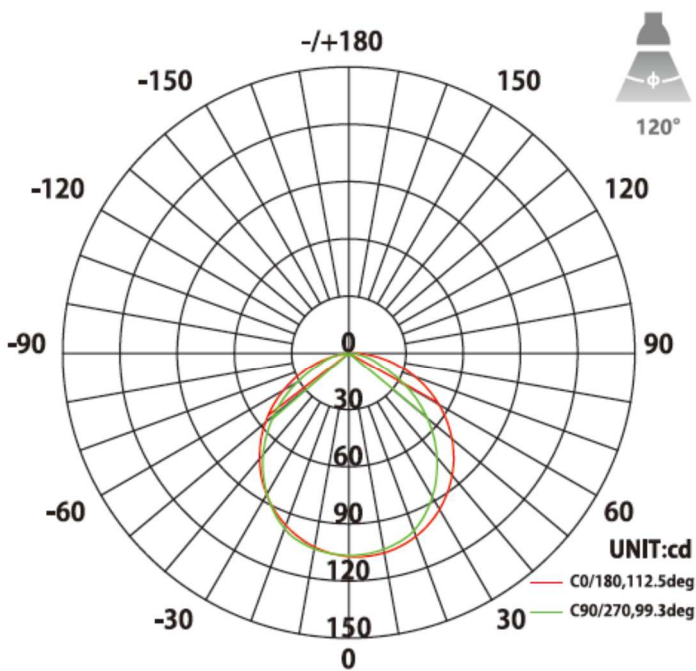

AVERAGE BEAM ANGLE(50%):105.9 DEG

Flux out:305.4 lm

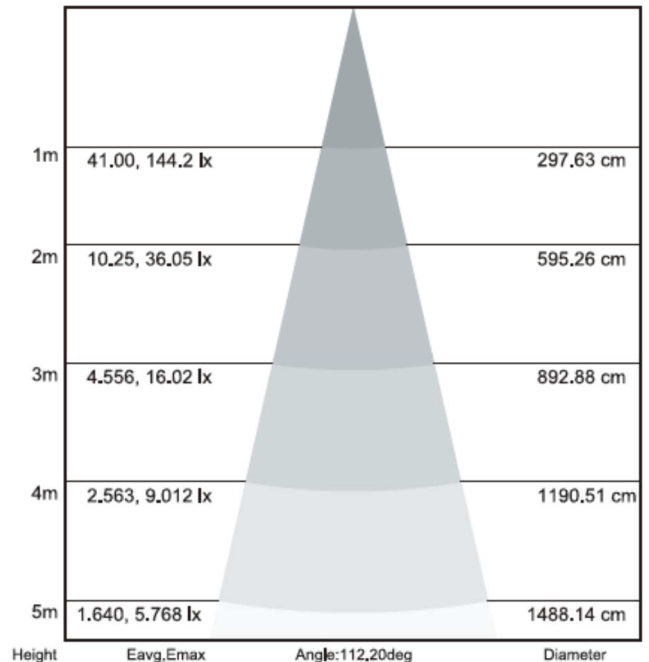

Note: The Curves indicate the illuminated area and the average illumination when the luminaire is at different distance.

Installation Instruction

J
/
B
O
X

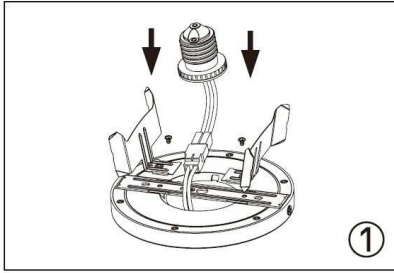

Remove trim and existing lamp from recessed fixture;

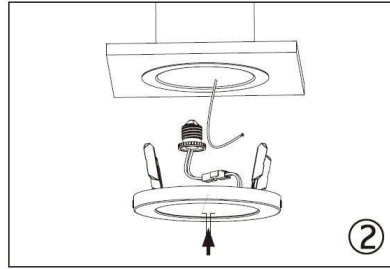

Screw E26 Socket adapter into socket in housing;

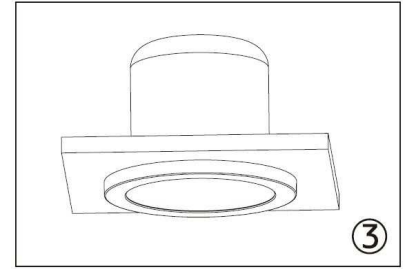

Press the friction blade to insert the lamp into the housing and restore power.

S
U
R
F
A
C
E

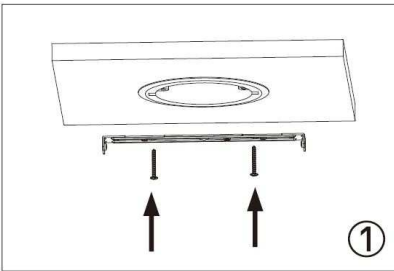

Fixing bracket on terminal box;

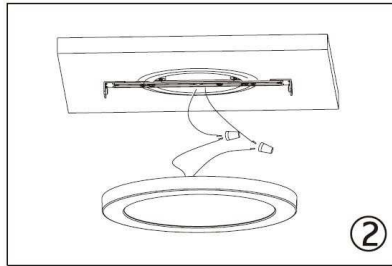

Connecting the wires;

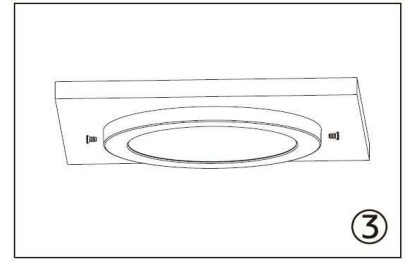

Fixing the lamp body on bracket and fix tightly.

Product and Packing Information

| Model | Outer Carton Size (L×W×H) | Qty/Carton (pcs) | N.W./Ctn (lbs) | G.W./Ctn (lbs) |
|-----------------|---------------------------|------------------|----------------|----------------|
| TL-FDPL1-7-9W | 12.0" x 11.6" x 11.8" | 60 | 29 lbs. | 32 lbs. |
| TL-FDPL1-9-13W | 15.2" x 8.3" x 15.4" | 40 | 42 lbs. | 44 lbs. |
| TL-FDPL1-9-18W | 18.7" x 8.3" x 9.5" | 20 | 26 lbs. | 29 lbs. |
| TL-FDPL1-12-24W | 12.6" X 08.3" x 12.6" | 10 | 26 lbs. | 29 lbs. |

| Model | Description | Input Watts | Delivered Lumens | Universal Voltage (VAC) | Max Line Current (Amp) @ 120 - 277 | THD | Power Factor | Weight |
|-----------------|-------------------------------|-------------|------------------|-------------------------|------------------------------------|-----|--------------|-----------|
| TL-FDPL1-7-9W | Flat Disk Panel Light 7 inch | 9 | 650 | 120 | 80mA | 30% | >0.9 | 0.45 lbs. |
| TL-FDPL1-9-13W | Flat Disk Panel Light 9 inch | 13 | 920 | 120 | 110mA | 30% | >0.9 | 0.76 lbs. |
| TL-FDPL1-9-18W | Flat Disk Panel Light 9 inch | 18 | 1,260 | 120 | 170mA | 30% | >0.9 | 1.02 lbs. |
| TL-FDPL1-12-24W | Flat Disk Panel Light 12 inch | 24 | 1,680 | 120 | 220mA | 30% | >0.9 | 2.20 lbs. |

