

## Wall Mount End Cap Bath Bars



MADE IN AMERICA

### Application

The end cap bath bar series of diffuser assemblies allow the lighting designer and manufacturer to produce a cost effective, yet elegantly styled luminaire.

## FEATURES & SPECIFICATIONS

---

### Attributes

By utilizing our spring clips with a standard 2-light strip fixture, a low cost luminaire with a high perceived value can be achieved.

### Diffuser

The diffuser assembly consists of a solid white, clear fluted, or white fluted profile mated to a choice of end cap sizes and colors. We have expanded the range of offerings on the End Cap Bar series to include a new Frosted Ribbed Diffuser. The new diffusers give the appearance of frosted glass, while maintaining the shipping and usage durability of acrylic. The diffuser is available with full range of standard caps, narrow caps, inclusive of all marble colors and trim options. The following information is used to specify the Frosted Ribbed Diffuser.

### Electrical

Only available with electronic ballasts for T8 lamps.

### Size

Available Sizes: 25-1/2" X 4-3/4" X 4", 37-1/2" X 4-3/4" X 4", or 49-1/2" X 4-3/4" X 4"

### Mounting

The spring clips, when fastened to the strip fixture, creates a pressure fit mounting method, allowing the completed luminaire to be suitable for either vertical or horizontal wall mounts.

### Options

A range of colors are available from basic opaque white to a family of marble effects. We have developed colors which can emulate effects of translucent alabaster or marble grains, or a variety of opaque faux marble finishes. We can also develop a custom end cap color, shape, or custom profile for proprietary applications if requested by the manufacturer.

### Listing

Fixtures conform to Underwriters' Laboratories standards for production and are carefully tested prior to packing.

---

**(972) 247-3171**

Factory/Warehouse • 2055 Luna Road • Suite 142 • Carrollton, TX 75006

(972) 247-3171 Phone • (972) 247-0200 Fax

Email [sales@texasfluorescents.com](mailto:sales@texasfluorescents.com)

Look For Complete Internet Catalog • [www.texasfluorescents.com](http://www.texasfluorescents.com)

# Wall Mount End Cap Bath Bars

## DIMENSIONS

**Standard End Cap (1 1/2" wide) - EC**

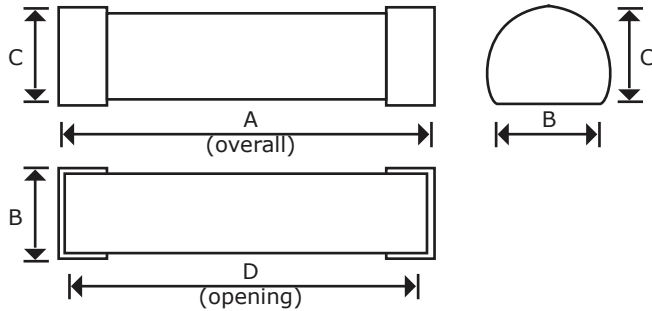

**Narrow End Cap (1/2" wide) - ECN**

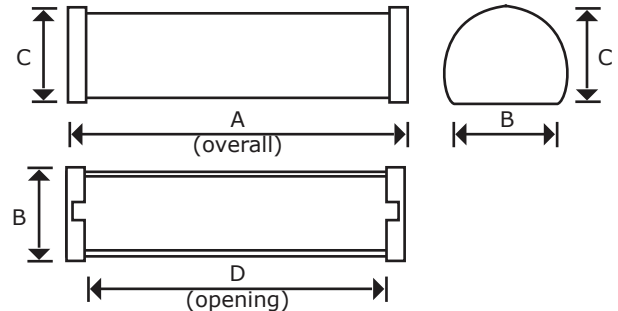

Series	A	B	C	D
VAN 217	25 1/2	4 3/4	4	24 1/8
VAN 225	37 1/2	4 3/4	4	36 1/8
VAN 232	49 1/2	4 3/4	4	48 1/8

Series	A	B	C	D
VANW 217	25 1/2	4 3/4	4	25
VANW 225	37 1/2	4 3/4	4	37
VANW 232	49 1/2	4 3/4	4	49

## ORDERING INFORMATION

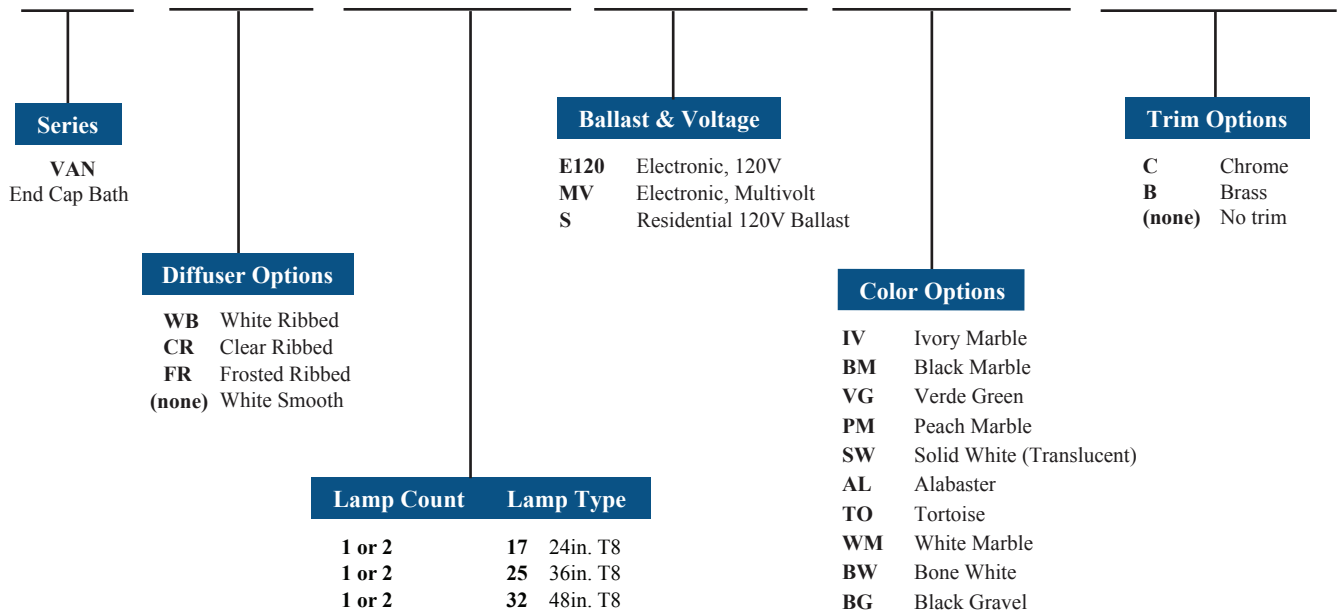

**(972) 247-3171**

Factory/Warehouse • 2055 Luna Road • Suite 142 • Carrollton, TX 75006

(972) 247-3171 Phone • (972) 247-0200 Fax

Email [sales@texasfluorescents.com](mailto:sales@texasfluorescents.com)

Look For Complete Internet Catalog • [www.texasfluorescents.com](http://www.texasfluorescents.com)