

VNT Series

120VAC LED DoB Linear Cloud Series
24", 36" and 48" lengths

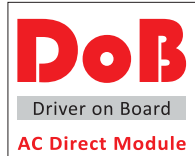

Catalog #		Type
Project		Date
Prepared by		

LED

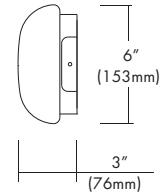
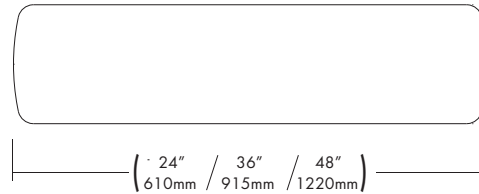

DESCRIPTION

The LED DoB Linear Clouds are designed for use in Bathrooms, hallways, Stairways, hospitals, etc. Ideal for new construction or replacing old fixtures over a J-box and can be ceiling or wall mounted. The High efficacy 120VAC LED DoB (Driver on Board) Module is integrated with an AC direct driver chip and does not require an external driver which increases reliability. The circuit also has integral triac dimming capability for added flexibility. The acrylic optical diffusing shade produces high lumen transmission and even illumination with no hot spots. Suitable for Damp Location.

DESIGN FEATURES

- Translucent white acrylic diffusing shade provides soft, even illumination with no hot spots.
- Mounting can be wall mounted or horizontally or vertically mounted on the wall.
- 120VAC LED module with integral IC chip on board and 10~100% triac dimmable with most of leading and trailing edge dimmer switches on the market.
- CSA approved and designed for hard wiring in a Junction box for ceiling or wall mounting.
- Circuit designed to protect against Inrush Current Surges.
- Damp Location approved.

Limited Warranty

- LED Module: 5 years/50K hours
- Product: 3 years

Listing

- cCSA-us Damp Location
- ENERGY STAR
- California Title 24

Specification

Model #	Dimension	Input Voltage	LED Wattage	Output Lumens (from diffuser)	CRI (Typical)	Color (+/-5%)	Finish
VNT24	24"L x 6"W x 3"H	120VAC	20W	1,400 lm	80, 90	2700K - 5000K	White
VNT36	36"L x 6"W x 3"H	120VAC	30W	2,100 lm	80, 90	2700K - 5000K	White
VNT48	48"L x 6"W x 3"H	120VAC	40W	2,800 lm	80, 90	2700K - 5000K	White

Ordering Information

Model	-CRI	Color Temp.*
VNT24 = 24", 20W Linear Cloud	-8 = 80 CRI	27 = 2700K
VNT36 = 36", 30W Linear Cloud	-9 = 90 CRI	30 = 3000K
VNT48 = 48", 40W Linear Cloud		35 = 3500K
		40 = 4000K
		50 = 5000K

Example: VNT36-830

* Consult factory for other Color Temperatures and Finishes