

W109D

Wall Sconce



Features

Housing

Die-formed Cold-rolled Steel

Optical

Shade: High Transmission Glass Creates Excellent Light Distribution and Uniformity

LED: High Efficiency, High CRI, Binned and Mixed to Reach Uniform Light

Electrical

Lamp

Integrate LED Module , 3000K LED

More Color Temperature Option 3500K, 4000K

Certification

ETL/cETL Listed

Warranty

5 Years Limited Warranty on Driver and LED

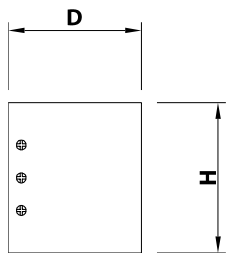

LED Type

Model	Input Voltage	Input Wattage	Lamp	LED CT	CRI	Lumen (TYP)	Finish/Shade	Dimension (W x H x D)	Energy Star
W109D	120V	8W	Strip	3000K	>80	500	White	9.8" x 4.5" x 4.0"	